

GENERAL NOTES
 1. PROVIDE JUNCTION BOXES AND CONDUIT STRIPUP 10' ABOVE SUSPENDED CEILING FOR EACH LOCATION DEVICES.

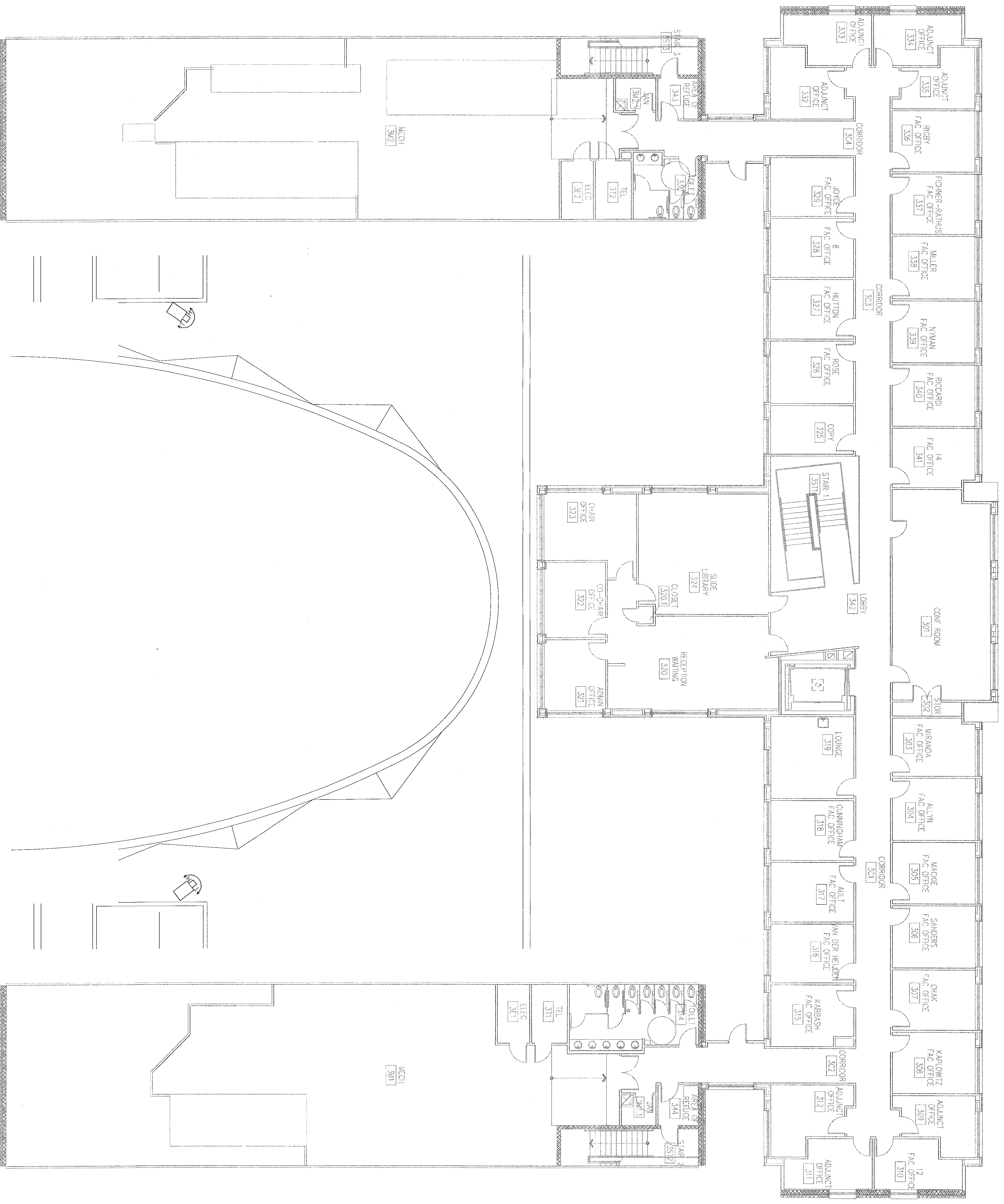

1 ELECTRICAL-SECURITY THIRD FLOOR

1/8"=1'-0"

KEY PLAN:

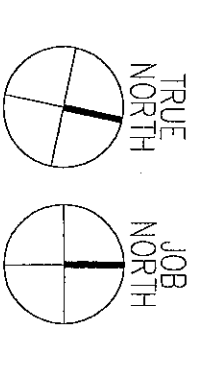

NO.	REVISION/SUBMISSION	DATE
1	ADDENDUM #3	4.1.2008

THE COLLEGE OF NEW JERSEY

New Art & IMM Building
 Ewing, New Jersey

DATE: 2.20.2008
 SCALE: 1/8"=1'-0"
 EYP PROJECT NO. 100604A.101
 DESIGNED BY: MG
 DRAWN BY: MG
 CHECKED BY: EN

ELECTRICAL-SECURITY THIRD FLOOR